

EDDYCHEK[®] S

Versatile yet economical eddy current testing

In today's highly competitive markets, eddy current testing has become a standard in assuring high quality products. At a very reasonable price, EDDYCHEK[®] S provides you with all of the essential testing features such as multi-channel, high-speed testing, defect marking and complete documentation of test results. It covers a wide range of applications in production line testing of tube, bar and wire. Simple service and trouble-free upgrades are yours thanks to the modular concept which also keeps costs down because you buy only what you need. The equipment can be operated from a PC where parameters are set up and test results are comprehensively documented.

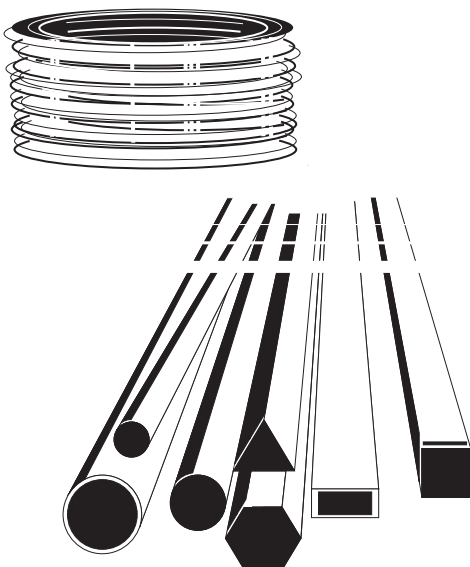
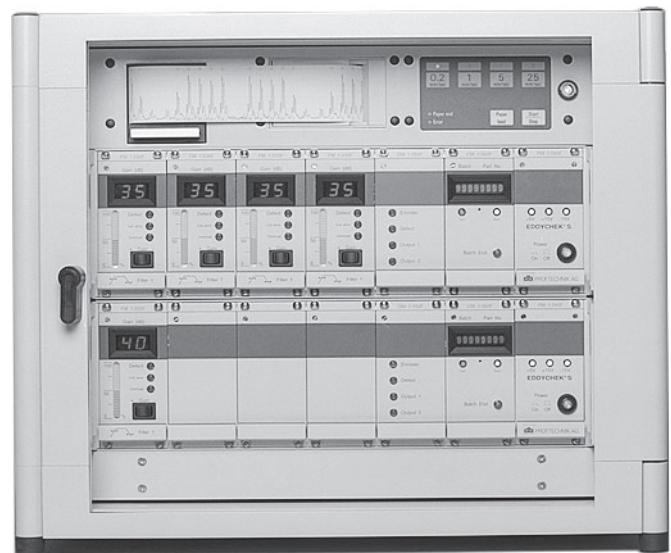

Features

- **Economical** solution to virtually all testing problems because of modular construction
- **Modern digital design**
- **Up to four testing channels per unit**
- **Complete documentation** of test results
- **Remote control** of testing via special PC software
- **Industrial housing** shielded against dust and electromagnetic interference.
- **Output signals:** Undelayed or delayed output signal to trigger alarm or other on-line process
- **Effortless service and quick updates**

The modular concept

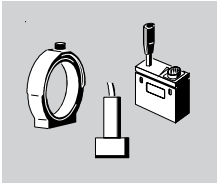

Front end unit

- Receives and processes signals from test coil or rotating system
- Adjustable signal amplification and filtering
- Simple bar-graph display of signals
- Defect signal (over 50 %) indicated by LED
- LED indicates defective coil and overload
- EDDYCHECK® S holds up to 4 front ends

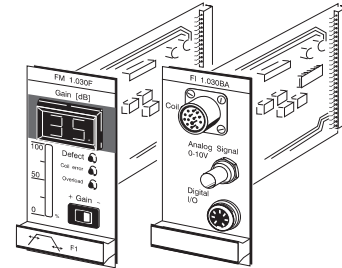

Front

Back

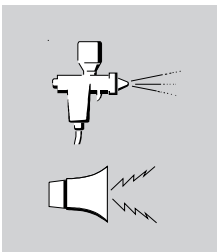

Delay unit (optional)

- For marking and sorting
- One undelayed and two delayed outputs
- One encoder input
- Monitoring of outputs, inputs and coil status by LEDs

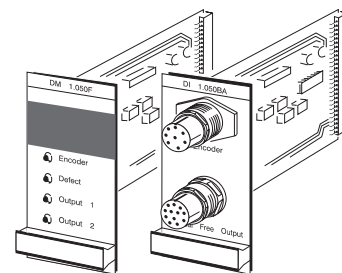

Front

Back



Communications unit (optional)

- Transmits data to PC which documents test results using PRÜFTECHNIK software
- Receives parameters set up on the PC
- Displays current batch and part number
- Monitors the computer interface

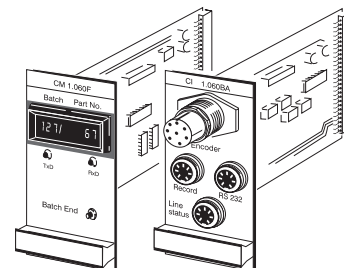

Front

Back

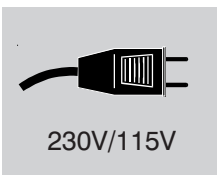

Power unit

- Control LEDs
- Conventional socket
- Adjustable 230V/115V
- Cable included

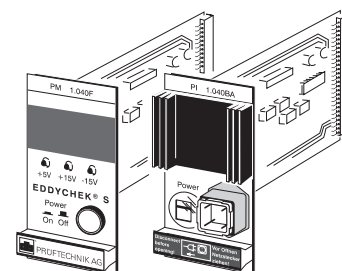

Front

Back

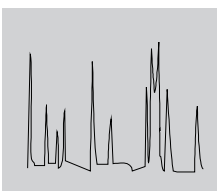

Recorder unit

- Writes signals from one or two channels on a thermal paper strip
- Adjustable paper transport speed
- Error and paper out LEDs

